

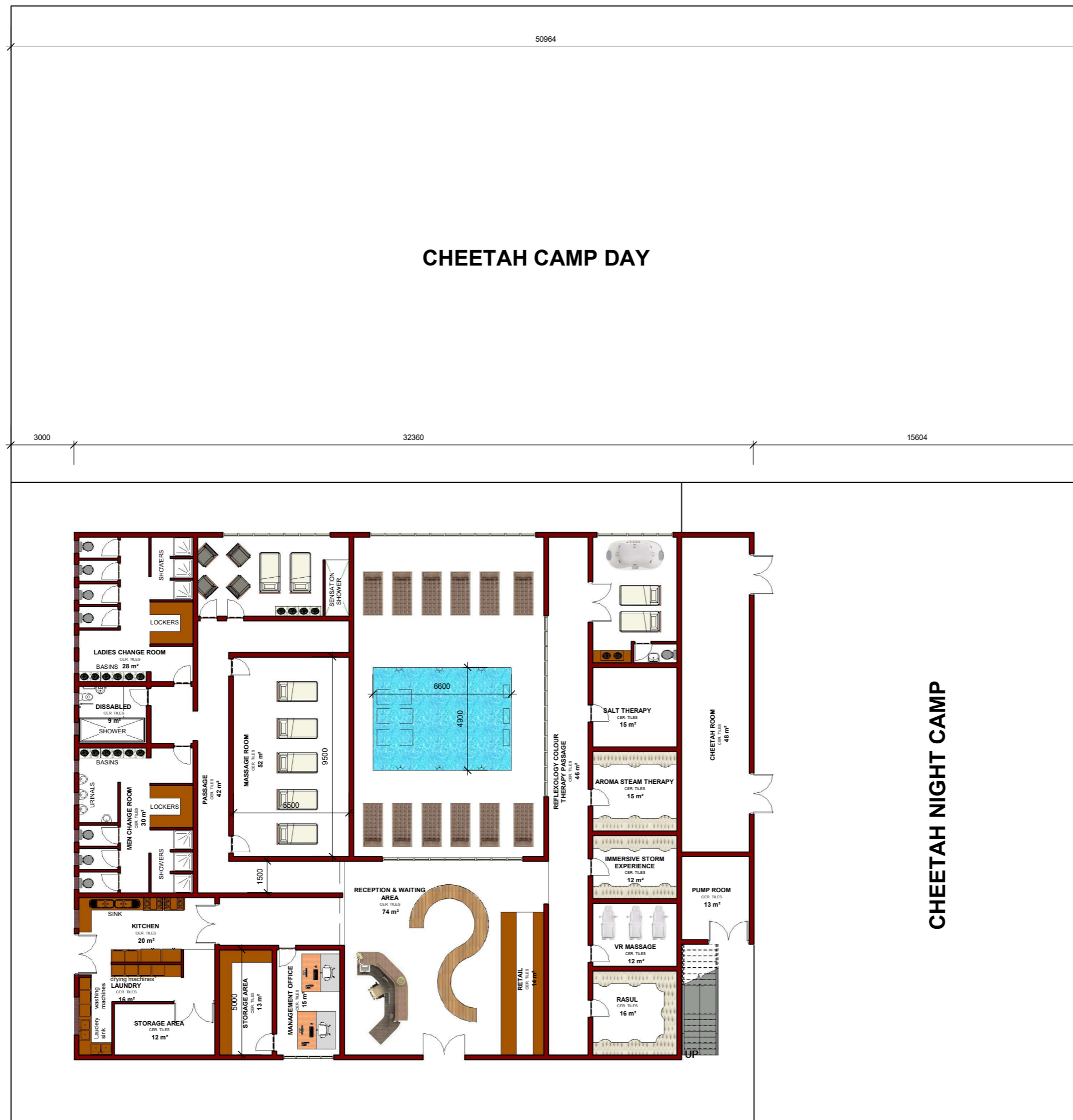

CHEETAH CAMP DAY



CHEETAH NIGHT CAMP

GROUND FLOOR

Scale 1:100

GENERAL NOTES

Do not scale drawings. Use figures dimensions only. All dimensions to be checked on site prior to any work commencement.

Any discrepancies, error or omissions to be reported to the draughtman immediately and no deviation from the original drawings shall be permitted.

All drawings and specifications to be in accordance with the National Building Regulations.

Provide dpc to all walls and window cills.

No variation or instruction shall override the contract or sub-contractor's obligation to comply with the requirements of the local authority.

Provide reinforce in every course of brick footing and every course for 4 courses above all doors, windows and openings.

Provide brickwork in every 4th course in all walls thereafter.

250 micron dpm under all ground floor slabs.

all slabs, foundations, beams, columns and roof trusses to engineers details.

Bricks on edge lintels over all doors, windows and opening to engineers details.

Quality of all materials and workmanship to comply with the relevant S.A.B.S and B.S.S specification and shall conform to the minimum standard specified in the standard preambles in the bills of quality relevant notes on working drawing.

The contractor is responsible for the correct setting out of the building, all external and internal walls with particular reference to boundaries, building lines etc.

Drainage notes:

All waste pipe to be easily accessible, all soil pipes to be minimum of 1:50 fall.

I.E.'s to all bends, junctions, changes in direction and distance exceeding 24m.

Deep reset traps to all waste fitting.

50 waste pipes to all sinks, shower and baths.

38 waste pipes to all wash hands basins.

50 A.S.V.P to all waste fittings exceeding 1300mm vertical drop.

No drain to be 900mm from concrete foundation.

Access covers to be provided to drainage ducts to detail.

Glazing:

All glass to be in accordance with N.B.R and S.A.B.S approved.

3mm thick glass for 0.075m
 4mm thick glass for 0.75-1.5m
 5mm glass for 1.5-larger area
 6mm thick glass for 1.5m-larger area- doors.

Owner

NEW PROPOSED SPA TREATMENT AREA

AREA (SQUARE METRES)

	TOTAL COVERED	
	SITE AREA	
	COVERAGE	
TOTAL BUILDINGS	FAR	
DRAWN BY	GIVEN MBEWE	
SACAP NO.		
DATE	01/02/2023	
PROJECT NO:	OLD-001	